



Ulleråker DP1 A & B SOLSTUDIER
2017-11-28

Solstudie - 21 Juni



21 juni 9.00



21 juni 12.00



21 juni 15.00



21 juni 17.00

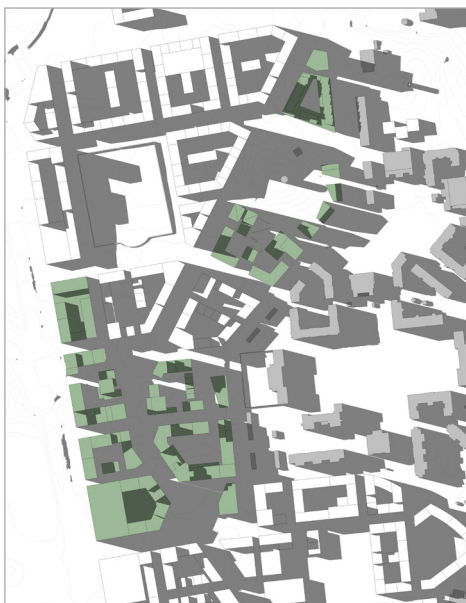

21 juni 18.00

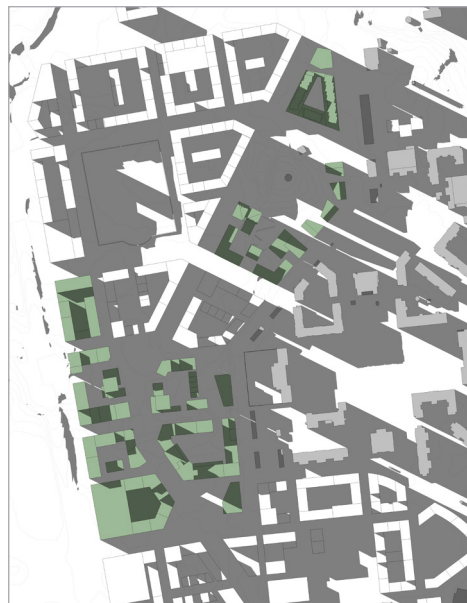

21 juni 19.00

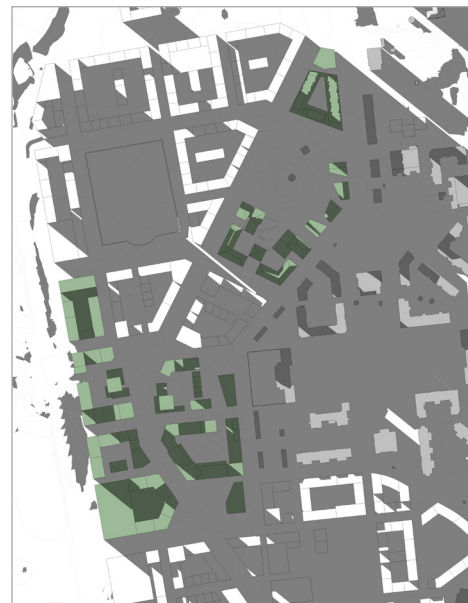

21 juni 20.00

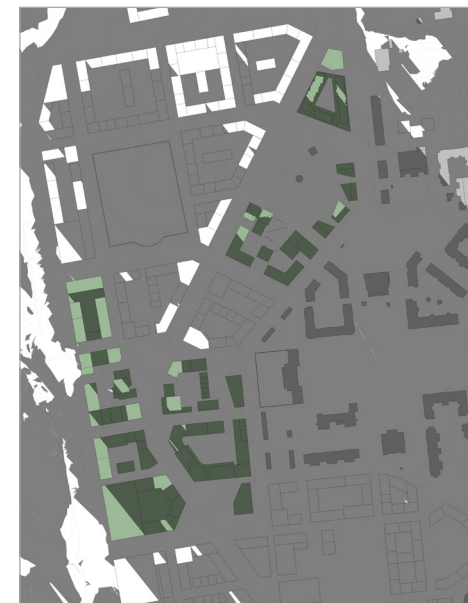

21 juni 21.00

Solstudie - 21 Juni med träd



21 juni 9.00



21 juni 12.00



21 juni 15.00



21 juni 17.00



21 juni 18.00



21 juni 19.00

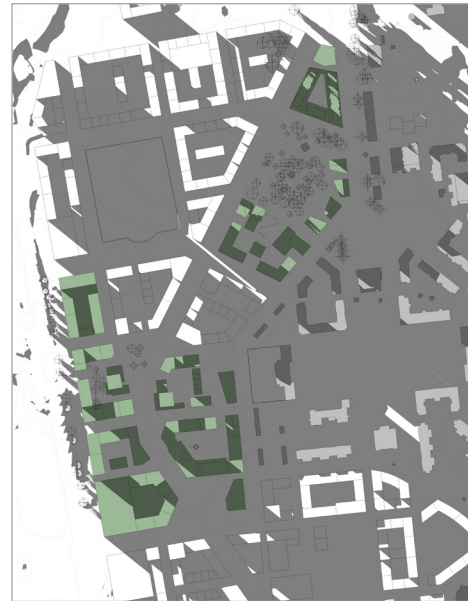

21 juni 20.00



21 juni 21.00

Solstudie - 21 juni

Befintlig bebyggelse

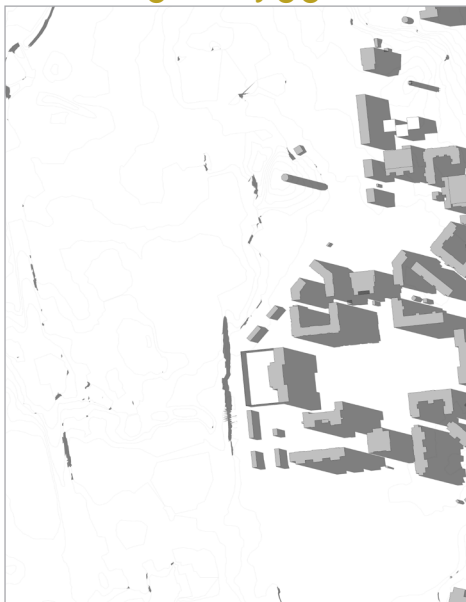

21 juni 18.00

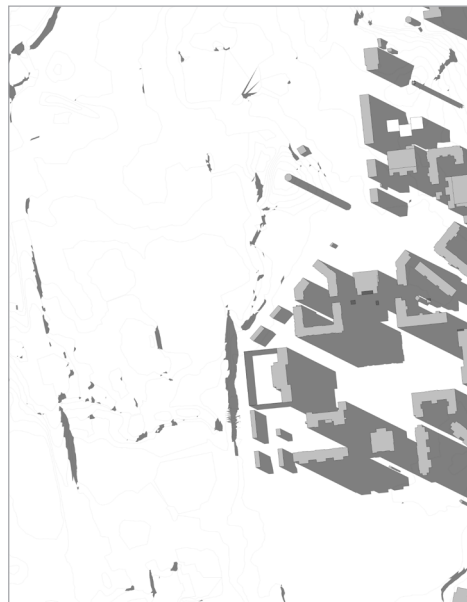

21 juni 19.00

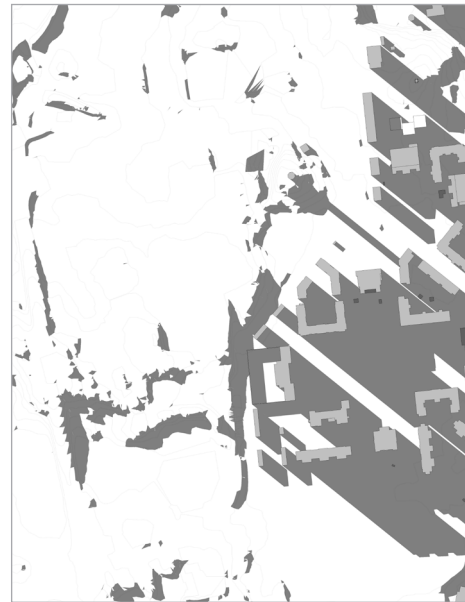

21 juni 20.00



21 juni 20.20



1 juni 21.00

Solstudie - 21 juni

Detaljplaner

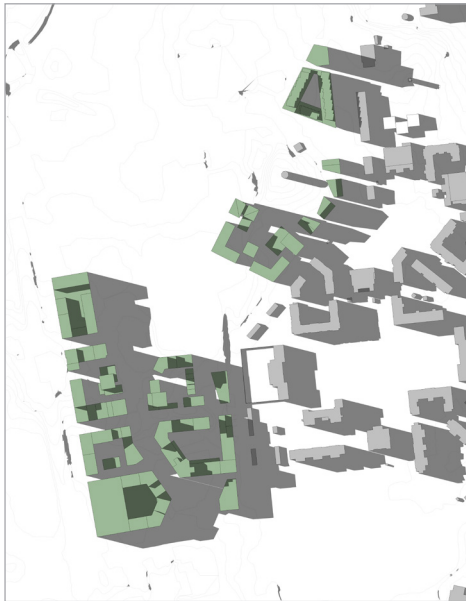

21 juni 18.00

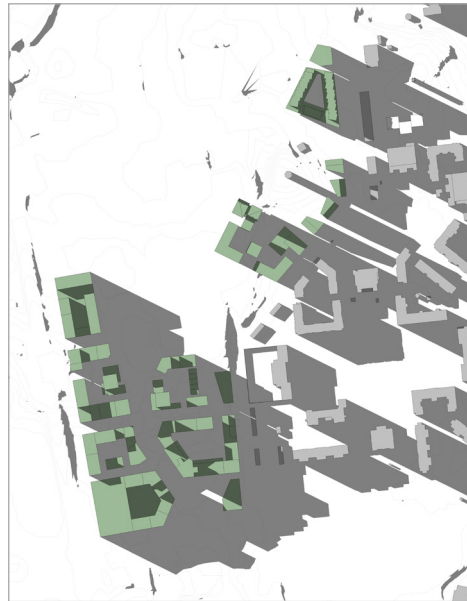

21 juni 19.00

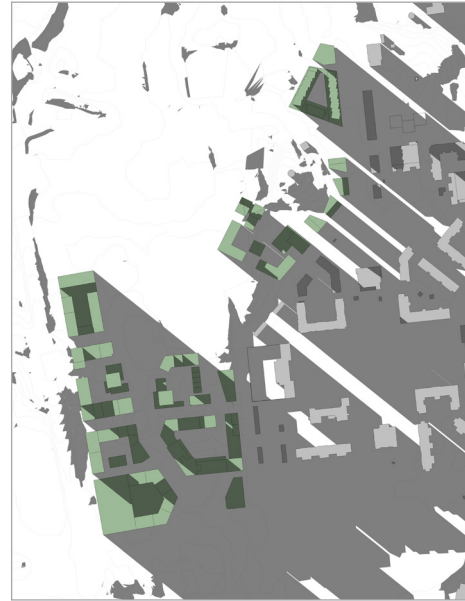

21 juni 20.00

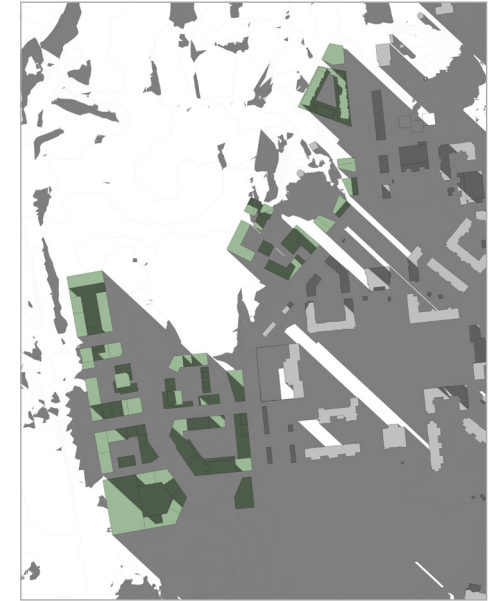

21 juni 20.20

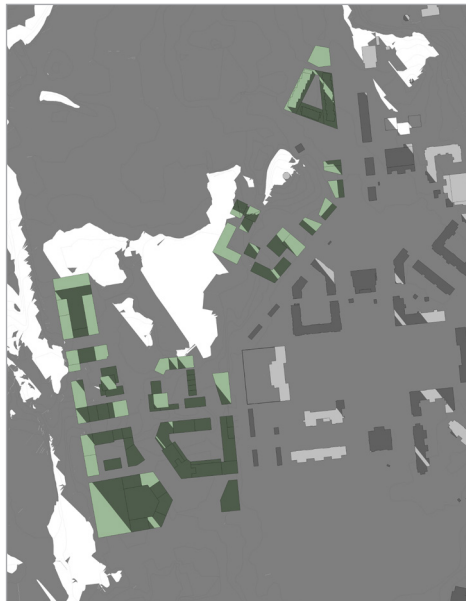

21 juni 21.00

Solstudie - 21 juni med träd

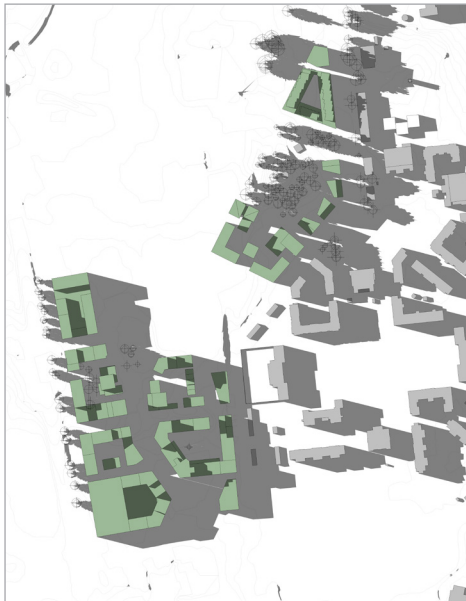

21 juni 18.00

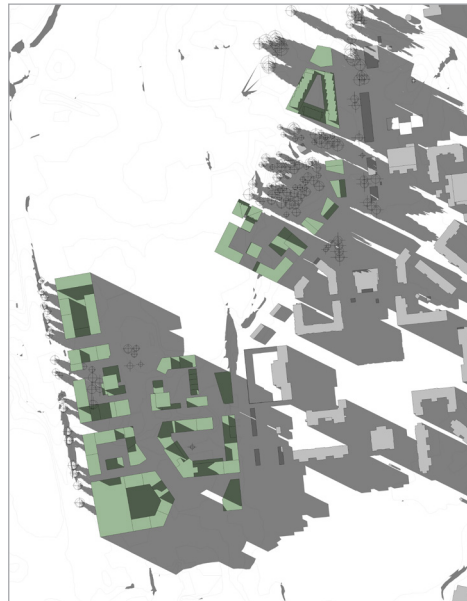

21 juni 19.00

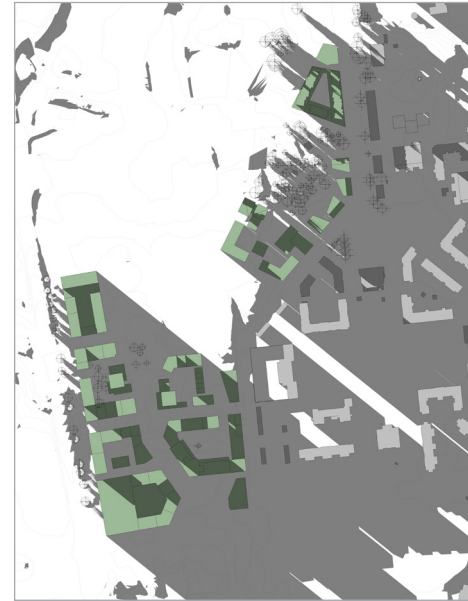

21 juni 20.00

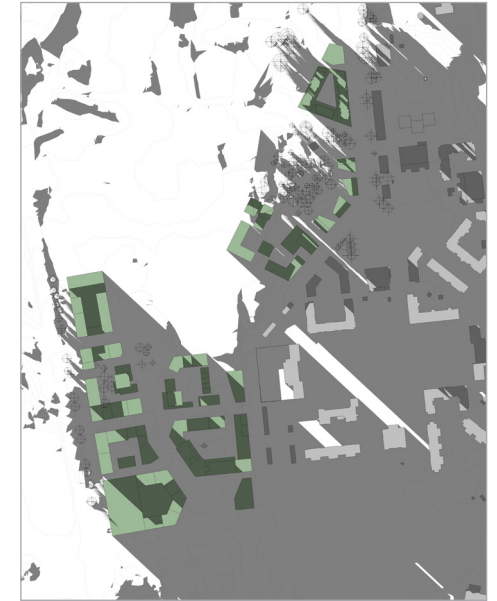

21 juni 20.20

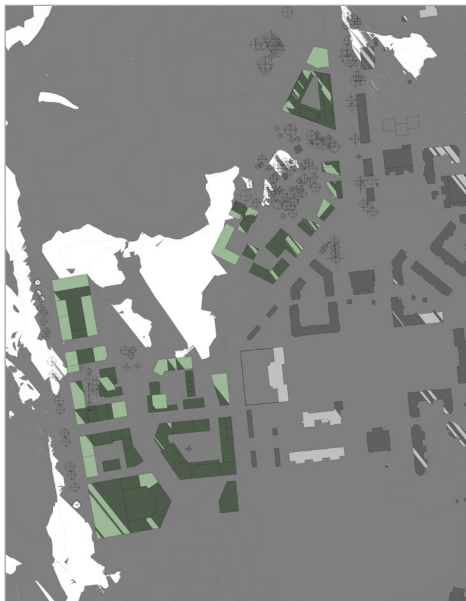

21 juni 21.00

Solstudie - 21 juni

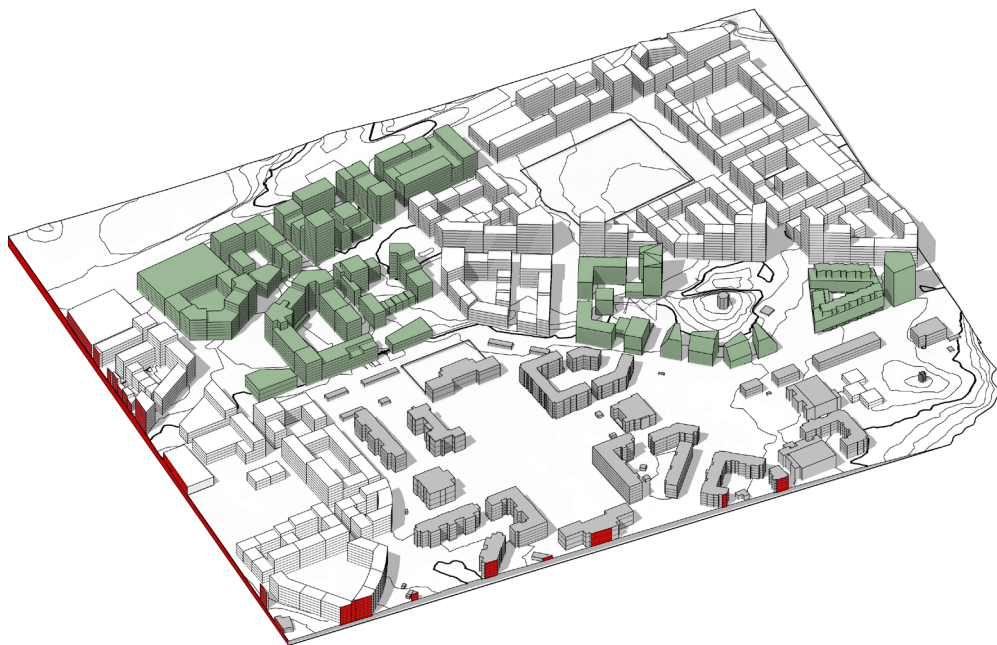

21 juni 11.00



21 juni 18.00

Solstudie - 21 juni med träd

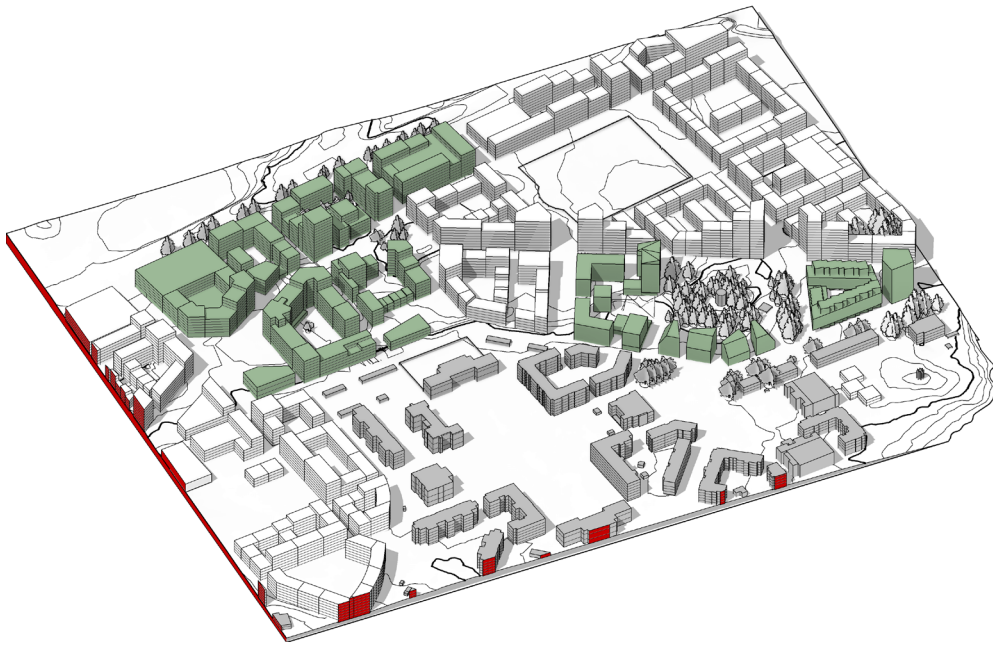

21 juni 11.00



21 juni 18.00

Solstudie - 1 april



1 april 9.00



1 april 12.00



1 april 15.00

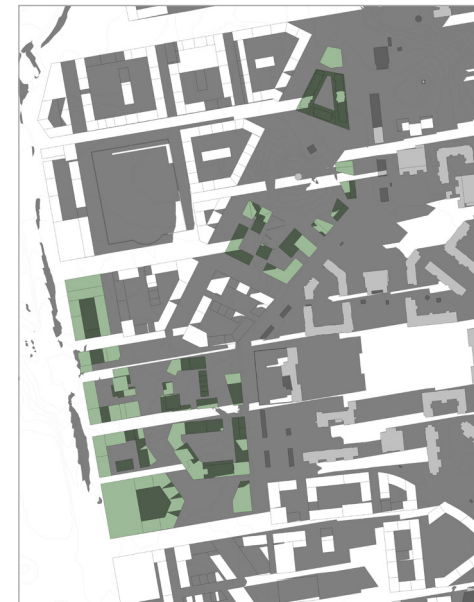

1 april 17.00

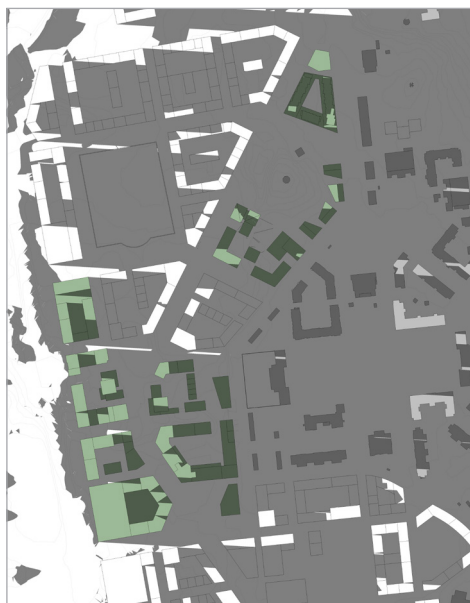

1 april 18.00



1 april 19.00

Solstudie - 1 april med träd



1 april 9.00



1 april 12.00



1 april 15.00

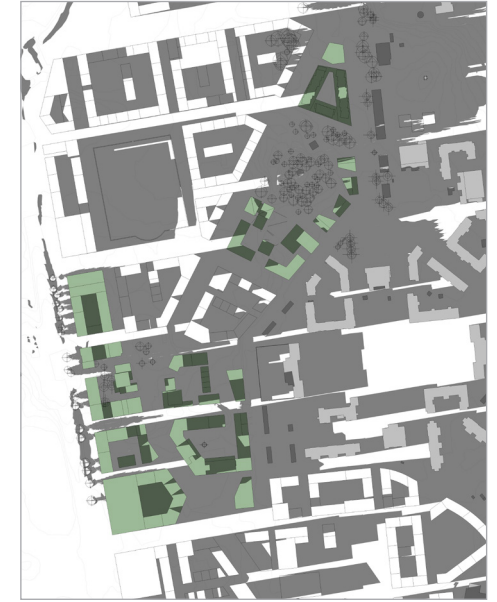

1 april 17.00

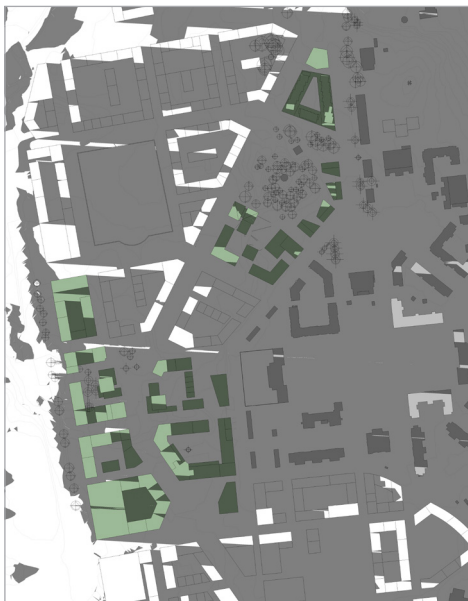

1 april 18.00

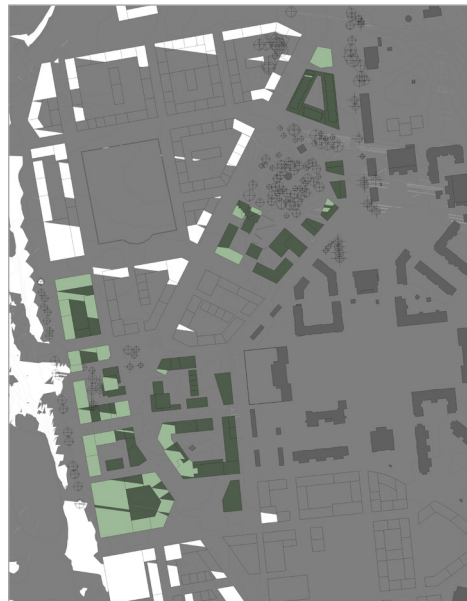

1 april 19.00

Solstudie - 1 april

Befintlig bebyggelse

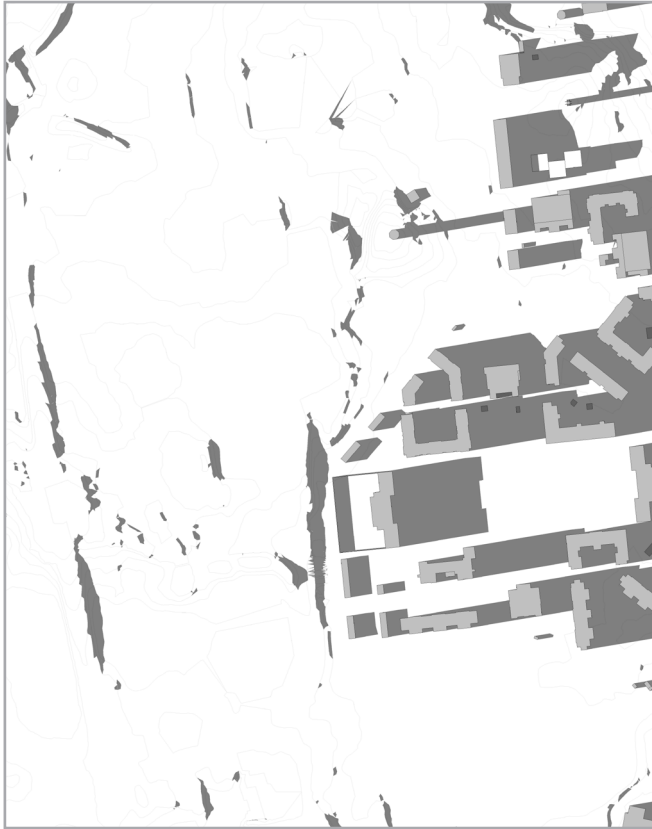

1 april 17.00



1 april 18.00

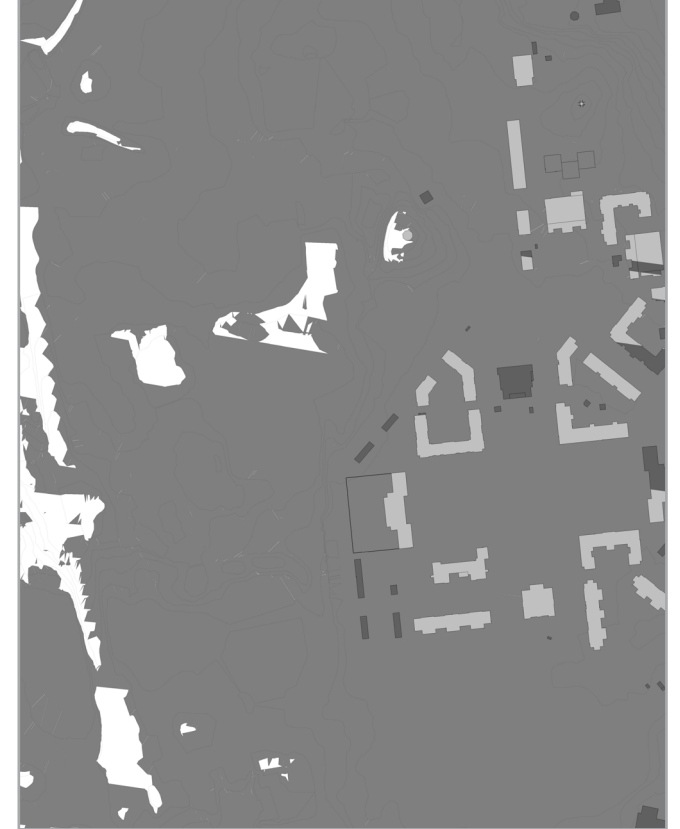

1 april 19.00

Solstudie - 1 april

Detaljplaner

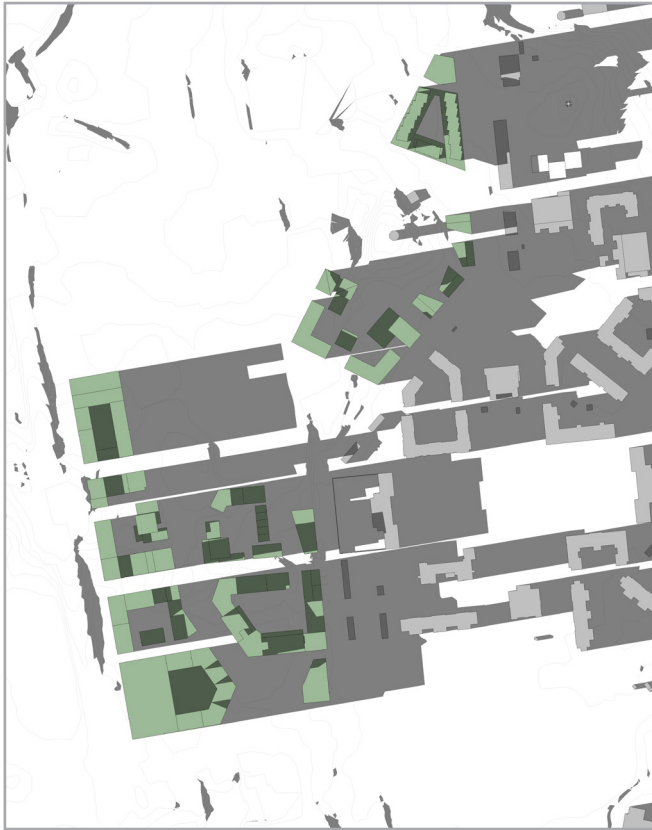

1 april 17.00

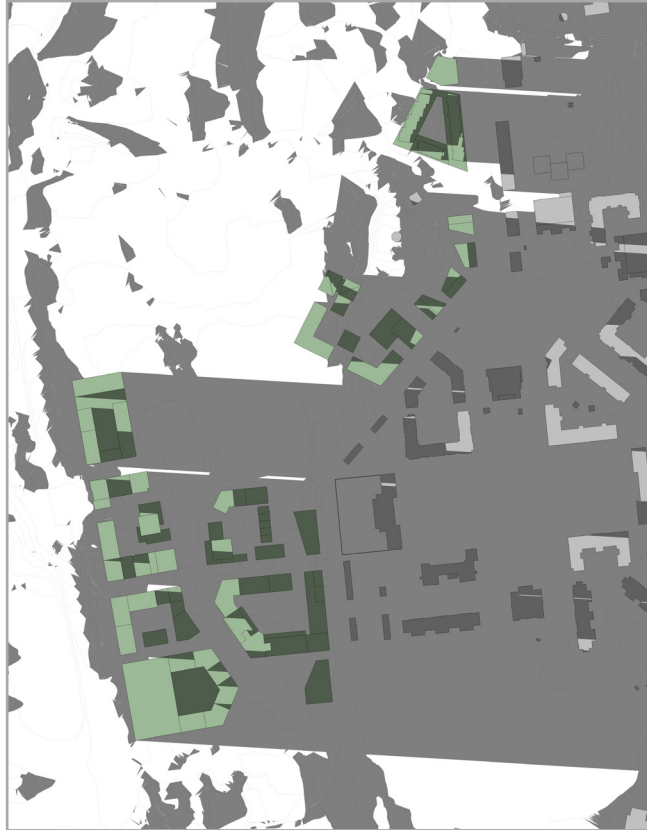

1 april 18.00

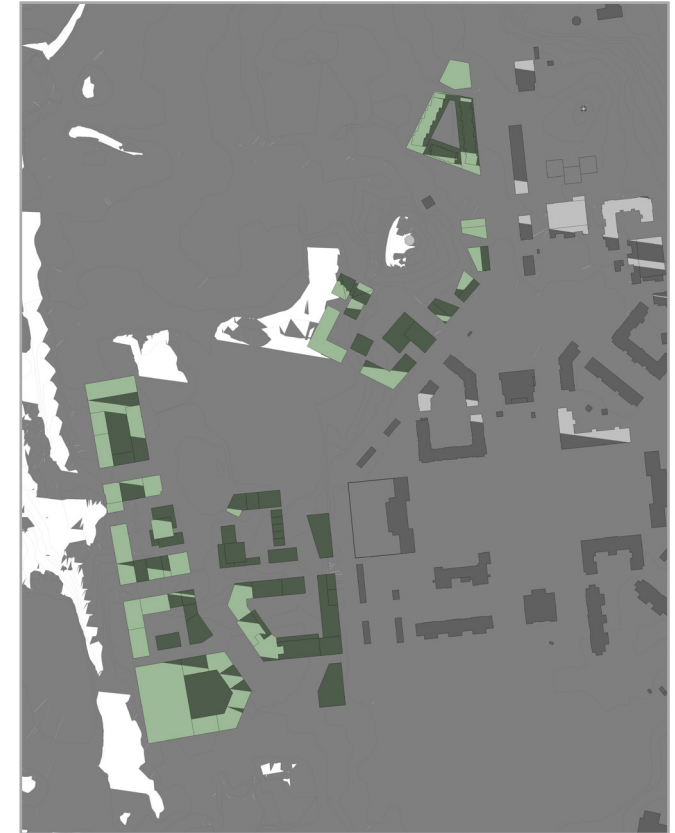

1 april 19.00

Solstudie - 1 april med träd



1 april 17.00

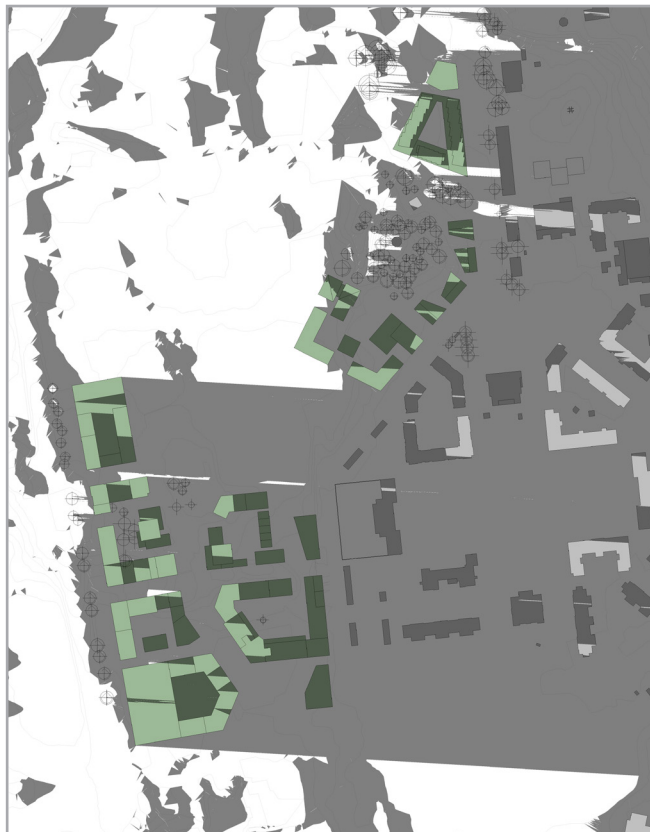

1 april 18.00

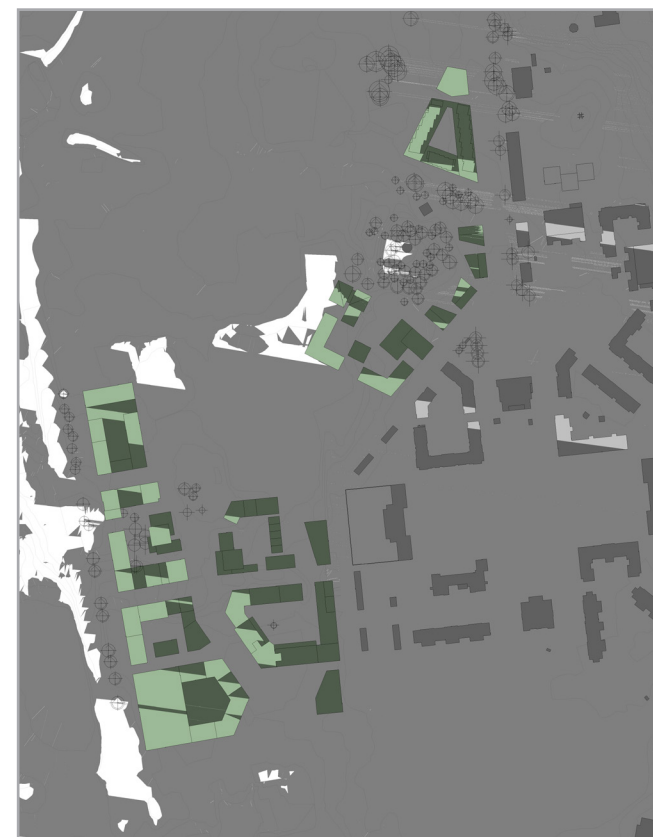

1 april 19.00

Solstudie - 1 april



1 april 10.00



1 april 17.00

Solstudie - 1 april med träd

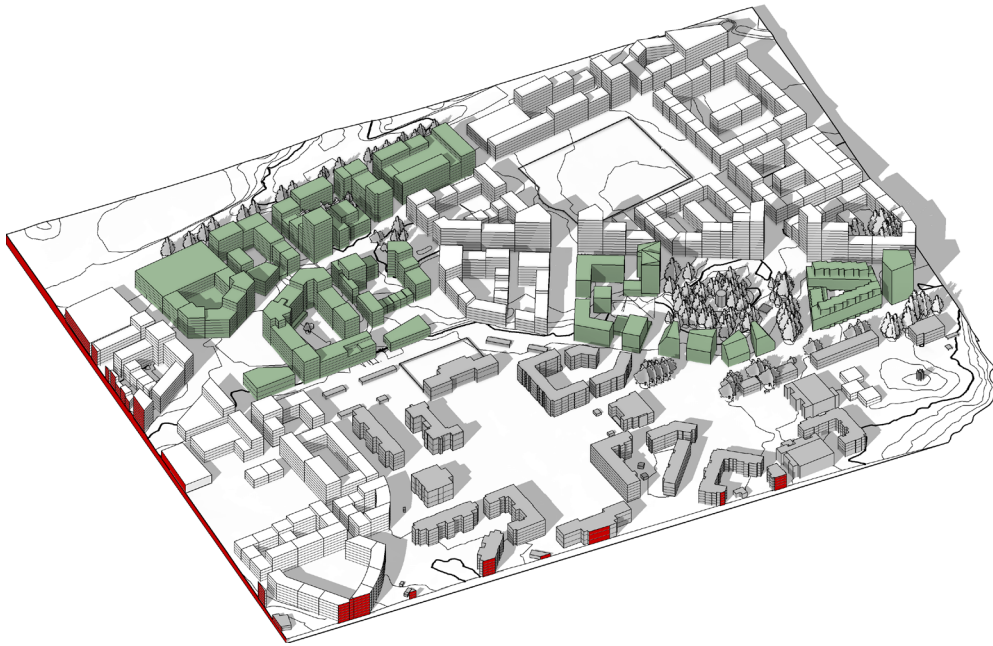

1 april 10.00



1 april 17.00